

## Pillar Pagoda Lite

|          |
|----------|
| PROJECT: |
| TYPE:    |
| SOURCE:  |
| NOTES:   |

### PURELED SPECIFICATIONS PER END

|                                  |  |
|----------------------------------|--|
| <b>LED Chip</b>                  | Cree XHP-50-2 Plug and Play field replaceable LED board  |
| <b>Luminaire Output Per Head</b> | 510 Lumens @ 1050mA (6 watts),<br>340 Lumens @ 700mA (4 watts),<br>160 Lumens @ 350mA (2 watts),<br>delivered from luminaire with unobstructed beam. |
| <b>Lumens Per Watt</b>           | 85 Lumens minimum @ 6 watts,<br>delivered from luminaire with unobstructed beam  |
| <b>CRI (3000K)</b>               | 90+  |
| <b>Colour Temperatures</b>       | 2700K, 3000K, 4000K  |
| <b>Beam Angles</b>               | 15, 25, 38, 60/360   |
| <b>Ingress Protection</b>        | IP66   |
| <b>Warranty</b>                  | Electronics = 5 years<br>Body Cop/ SS = 10 years<br>Body Aluminium = 5 years   |
| <b>Standards</b>                 | AS/NZS 61046, EN60598<br>cUL 1838, 2108, 1598<br>CSA C22.2 No. 250.7, No. 250.0-08,<br>No. 250.0<br>CE   |

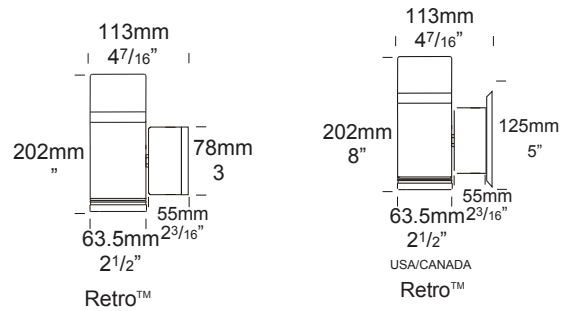
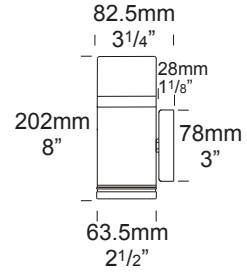

### PRODUCT CONFIGURATION

Please fill in appropriate codes into boxes provided

Cat. No. PILPGL/L

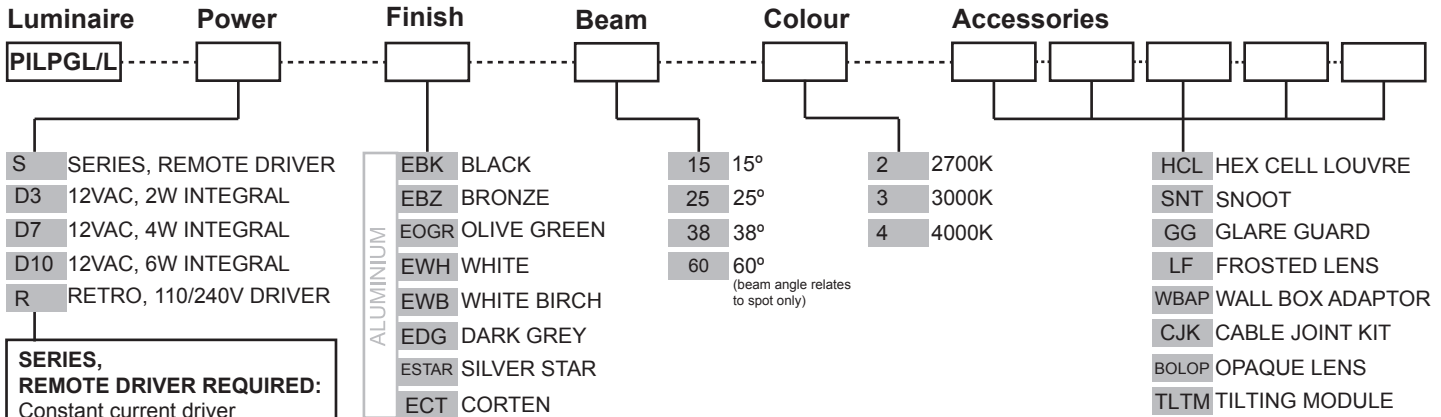

**SERIES, REMOTE DRIVER REQUIRED:**  
Constant current driver  
Individual fixtures require 12vdc @ 1050mA maximum

**12VAC INTEGRAL DRIVER:**  
Hunza integrated plug and play driver (included)  
Input: 9-15VAC.  
Output: 6vdc @ D3=350mA, D7=700mA, D10=1050mA (1050mA limited to ≤ 40°C (104°F) ambient temperature in stainless steel)

**110/240VAC RETRO DRIVER:**  
Input: 120/240vac, 5 watt total (driver included)  
Output: 12vdc, 700mA  
0-10 volt dimming (USA - non dimming)

**OTHER LAMP OPTIONS:**  
PILPGL/H - G4 Halogen 12V Lamp  
PILPGL/GL - G4 LED Retrofit 12V Lamp (lamps vary by market - please refer to supplier for details)

[Click here for 240v Remote Power Supply Guidance Charts](#)  
[Click here for USA Remote Power Supply Guidance Charts](#)

[Click here for halogen specification sheet](#)

# LUMINAIRE CONSTRUCTION

**CNC machined from one of the following metals:**

**Aluminium:**

Body: high corrosion resistant 63.5mm (2<sup>1/2"</sup>) x 10mm (3/8") aluminium.

Base and Mounting Plate (Retro™): handspun 2mm aluminium disk. Base cast from virgin high corrosion resistant CC401 low copper aluminium alloy chromate substrate and high UV resistant polyester powder coat.

Colours:

Black, Bronze, Silver Star, White, White Birch, Olive Green, Dark Grey, Corten.

**Copper:**

Body: 63.5mm (2<sup>1/2"</sup>) x 10mm (3/8").

Base and Mounting Plate (Retro™): handspun 2mm (5/64") copper disk and forged brass.

**316 Stainless Steel:**

Body: 63.5mm (2<sup>1/2"</sup>) x 10mm (3/8").

Base and Mounting Plate: investing cast and CNC machined 316 stainless steel.

**Lens:**

UV stable clear polycarbonate with stainless anti-glare mesh

**Gaskets:**

Silicone, iron impregnated 220°C (428°F)

**Mounting:**

12 volt: the luminaire is mounted to the wall using two 316 stainless screws through a shallow base 28mm (1<sup>1/8"</sup>) in depth.

Retro™ (110/240-12volt): a mounting plate is fixed to the wall using two screws and the luminaire is fitted to the mounting plate.

**Luminaire Weight:**

Low voltage

Alum: 0.860kg (1lb 14oz)

Cop: 1.900kg (4lb 3oz)

SS: 1.800kg (3lb 15oz)

Retro™

Alum: 1.200kg (2lb 10oz)

Cop: 2.200kg (4lb 14oz)

SS: 2.100kg (4lb 10oz)

## ACCESSORIES

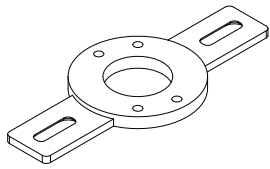

Wall Box Adaptor

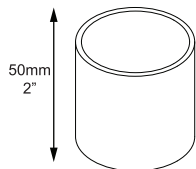

Snoot

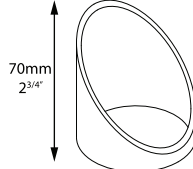

Glare Guard

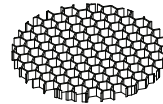

Hex Cell Louvre

## BEAM ANGLES

High efficiency PMMA TIR lenses. Field replaceable

IES files available for download: [hunzalighting.com/downloads](http://hunzalighting.com/downloads)

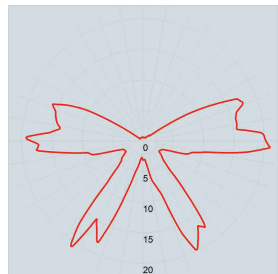

Polycarbonate lens top light source

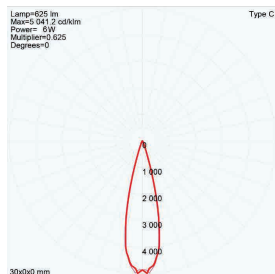

15° FWHM TIR spot light source

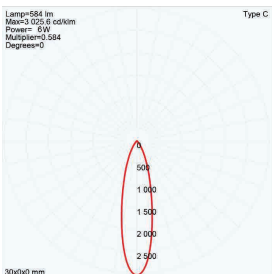

25° FWHM TIR spot light source

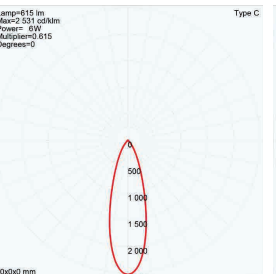

38° FWHM TIR spot light source

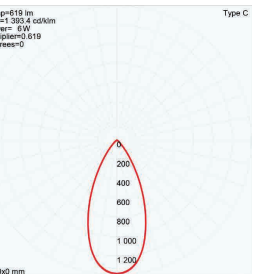

60° FWHM TIR spot light source

## WIRING GUIDE

**Series/remote driver**

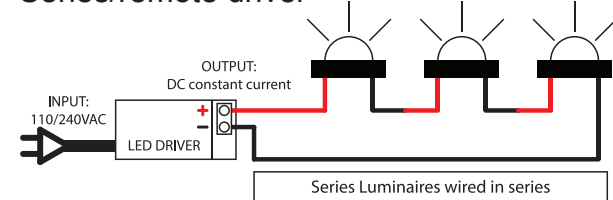

Diagrams are a guide only, wire colours and polarity may change depending on fixture and country

Available for download: [hunzalighting.com/downloads](http://hunzalighting.com/downloads)

**12v integral driver**

